

## GALASSIA

## Technical Info

Telaio in metallo verniciato.  
Pendagli in cristallo.  
Illuminazione Led.

Painted metal frame.  
Crystal pendants  
LED lighting.

Struktur aus lackiertem Metall.  
Kristallanhänger.  
LED-Beleuchtung.

Structure en métal peint.  
Pendentifs en cristal.  
LED éclairage.

МЕТАЛЛИЧЕСКАЯ  
СТРУКТУРА, В ОТДЕЛКЕ  
ХРОМ, С ПОДВЕСКАМИ ИЗ  
ПРОЗРАЧНОГО ИЛИ ЦВЕТНОГО  
КРИСТАЛЛА.

Estructura metálica en acabado  
cromado y colgantes de cristal  
transparente o coloreado.

这种灯具有金属结构（铬色），  
而且水晶的吊坠们  
（有色的和透明的）。

إطار معدني بلمسات نهائية من الكروم  
مع دلايات كريستال شفافة أو ملونة.

## Finishings

V98 Bianco gofrato  
Embossed white

## Pendants

**TRANSPARENT**  
Half cut glass /  
Cut crystal /  
Crystals from Swarovski®



TR Trasparente  
Transparent

# GALASSIA N1 DBL

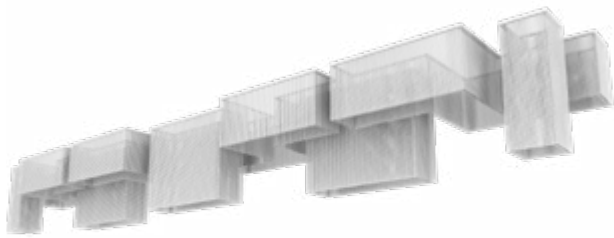

L 945 cm / 372.04"  
 SP 125 cm / 49.21"  
 H 100 cm / 39.37"  
 W 370 kg / 815.71 lb

LED x 451,2 W CRI > 95 3000K -  
 58092 Nominal lumen  
 Dimmable: 1-10V  
 (2 x driver recessed)

**Composition :**

- A** Combo A H100 (x2)  
4 x Corner 20x20
- B** Combo B H100 (x3)  
4 x Corner 20x20  
2 x Straight 100
- C** Combo C H50 (x4)  
8 x Corner 20x20  
2 x Straight 100  
4 x Straight 50

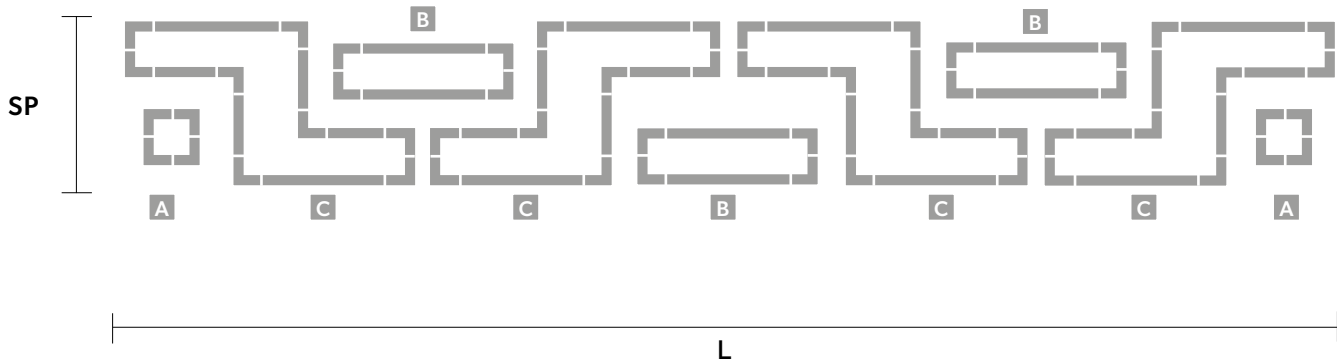

: for the US market, refer to the relevant price list.